

Hidden Winch Plate

Mounting instructions

for Land Cruiser 150/155

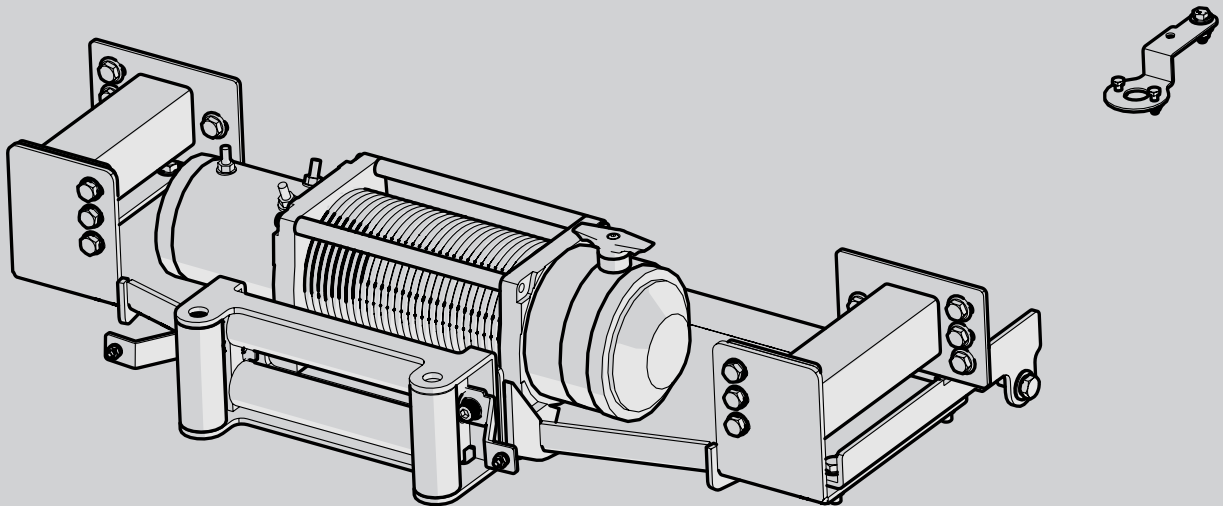

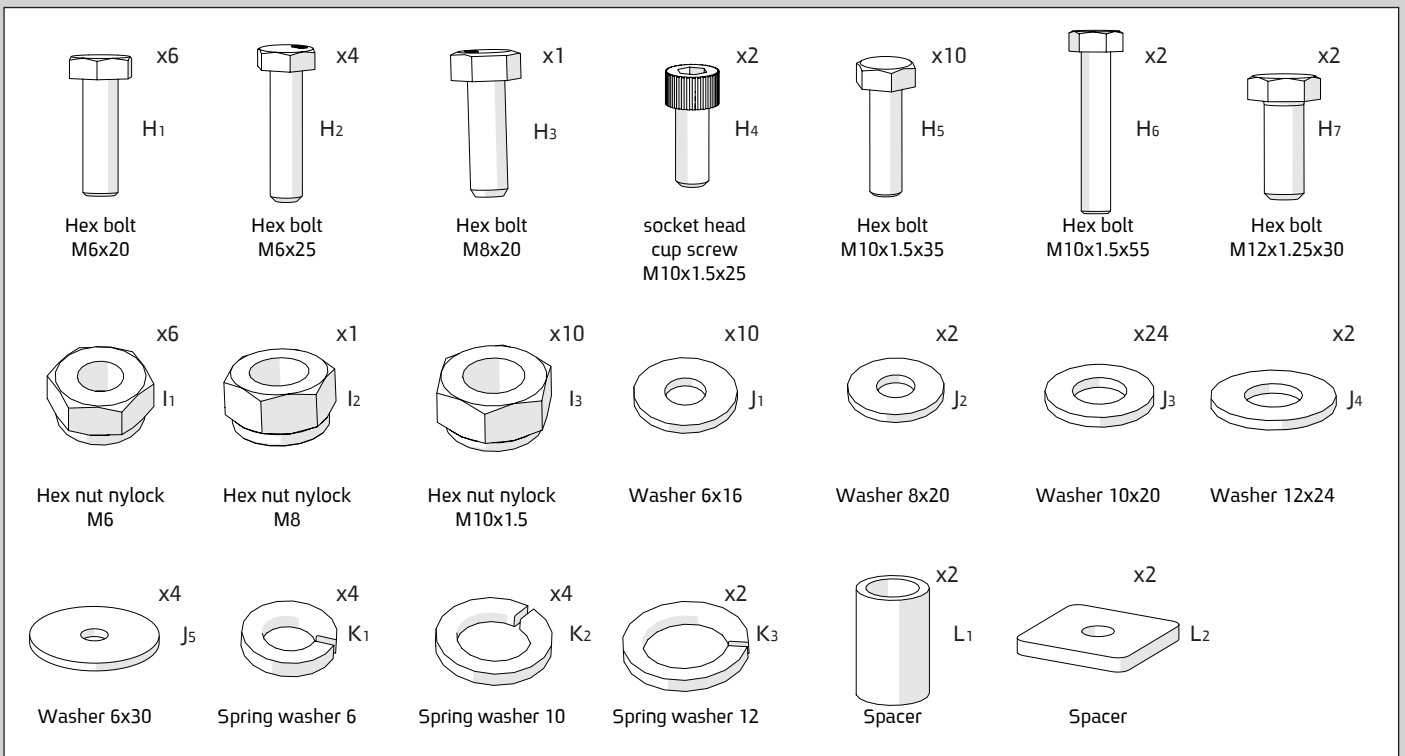
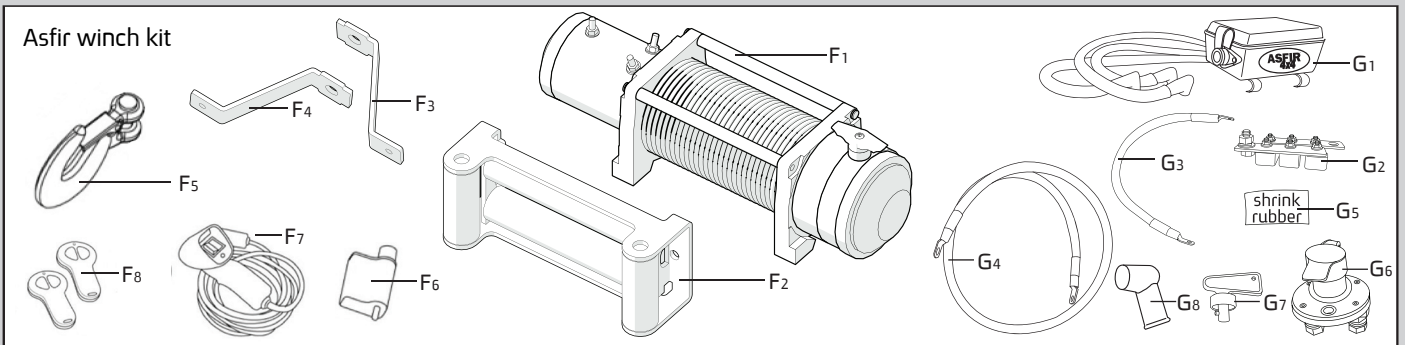
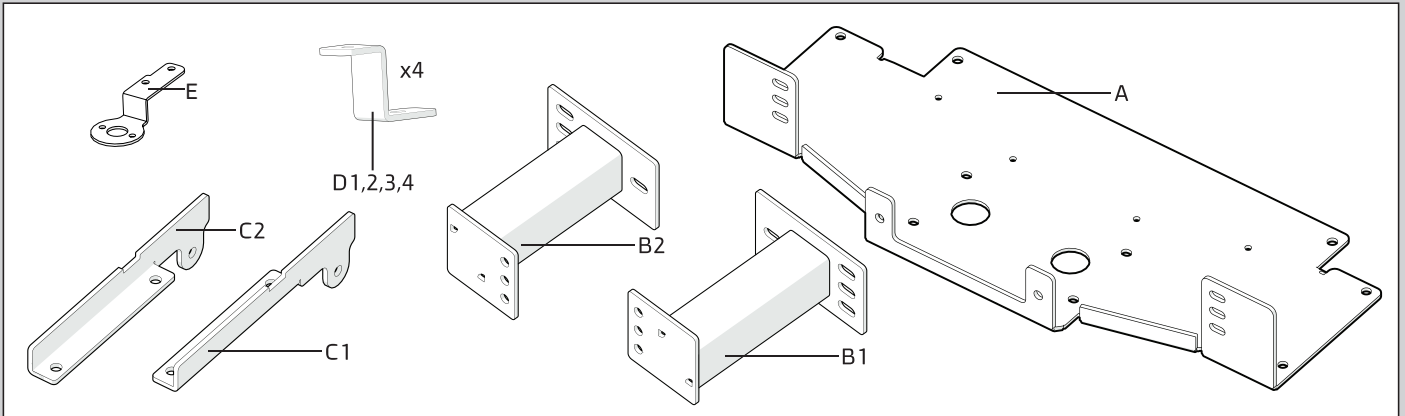

Maximum Tightening Torques	
M6 (8.8)	10 Nm
M8 (8.8)	25 Nm
M10 (8.8)	50 Nm
M12(8.8)	85 Nm

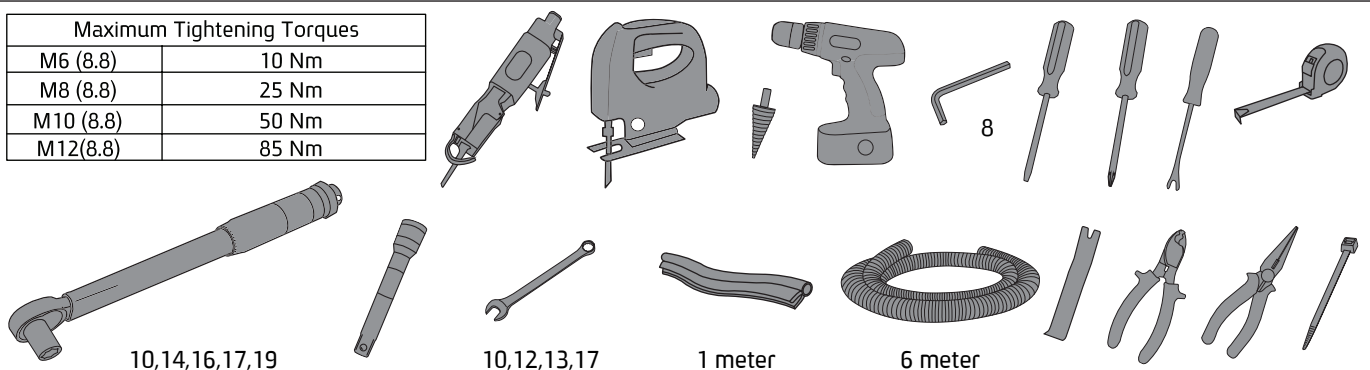

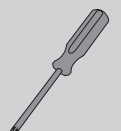
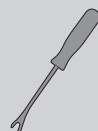
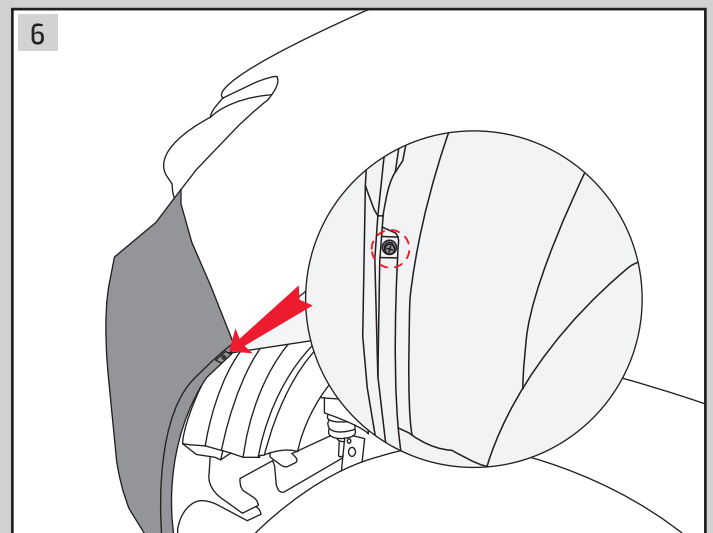
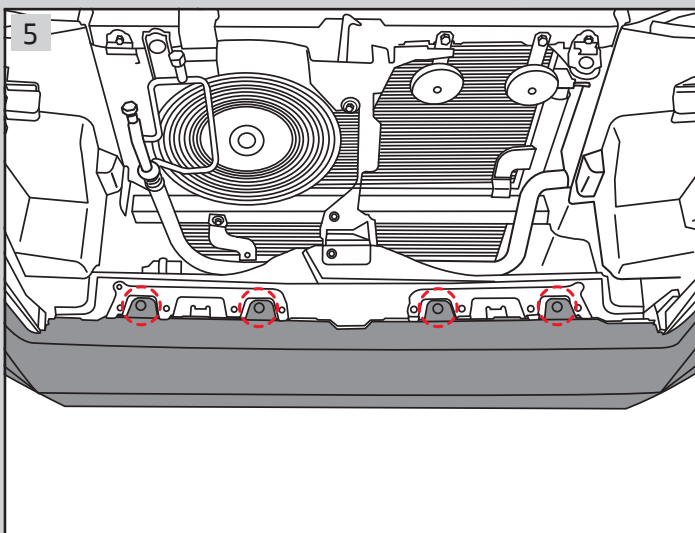
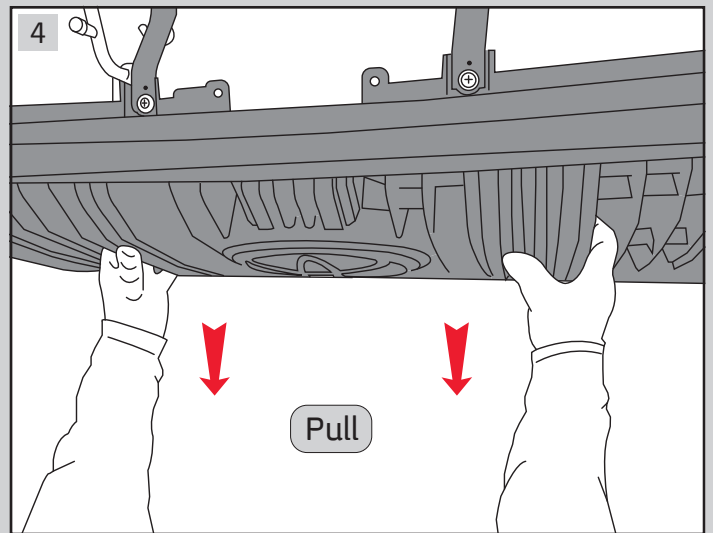
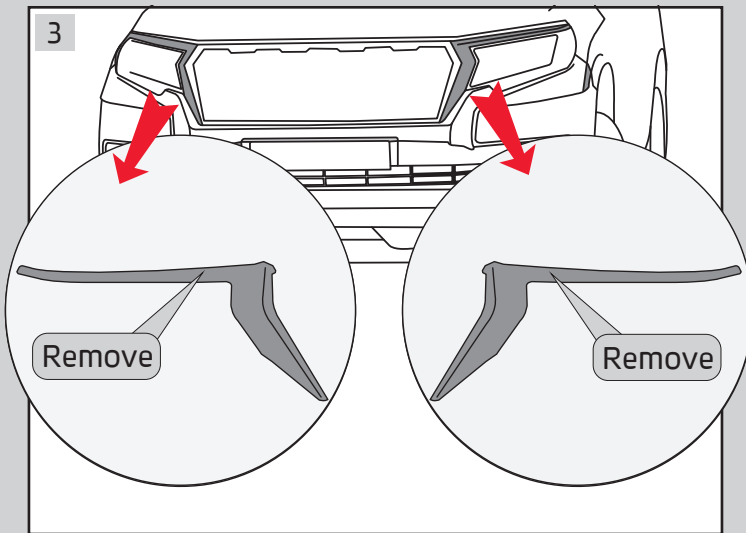
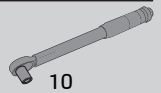
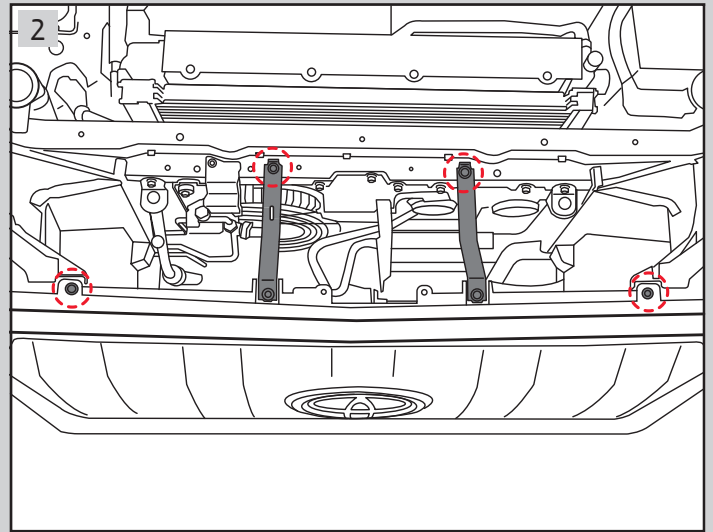
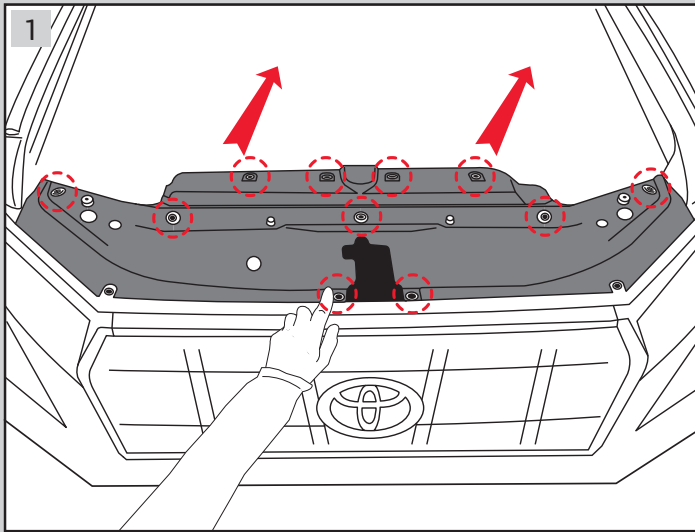

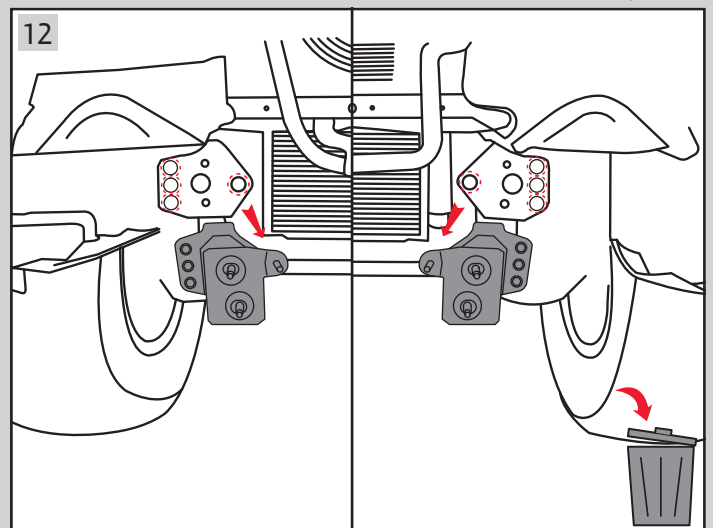
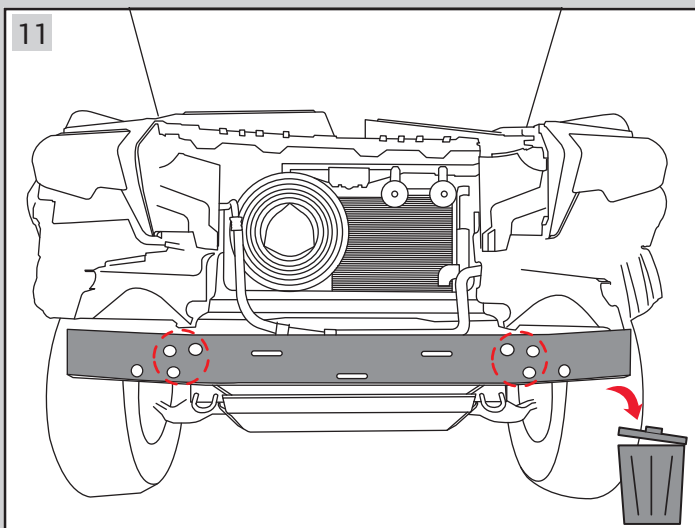
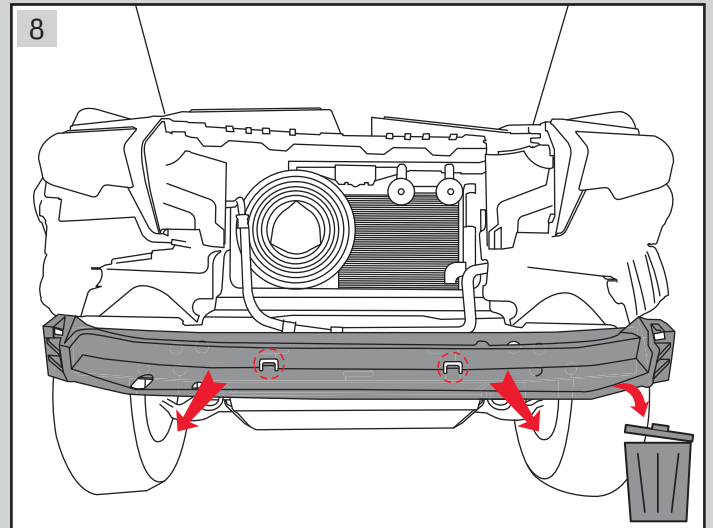
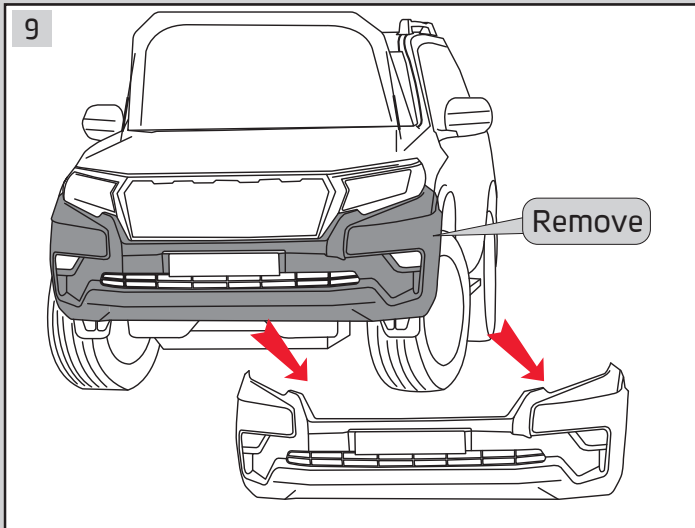
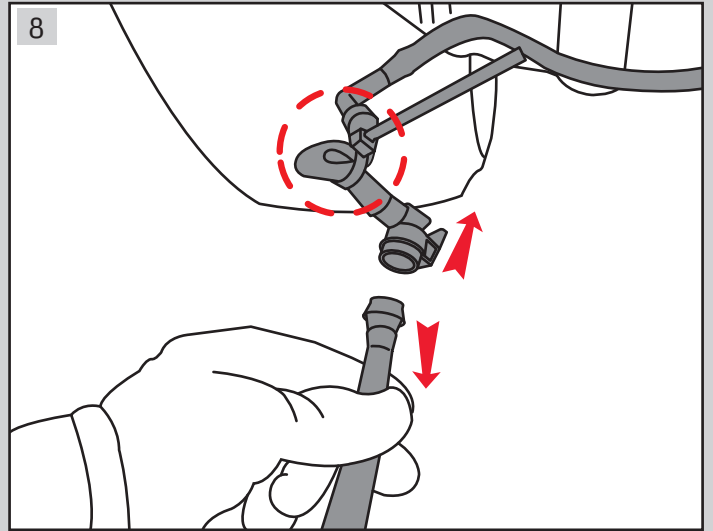
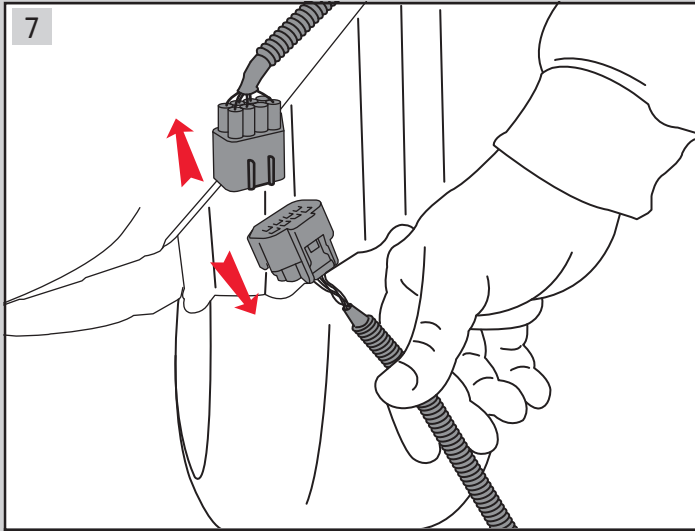

Keep original bolts

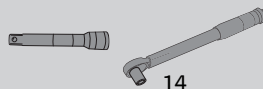

14

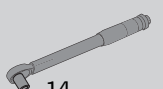

14

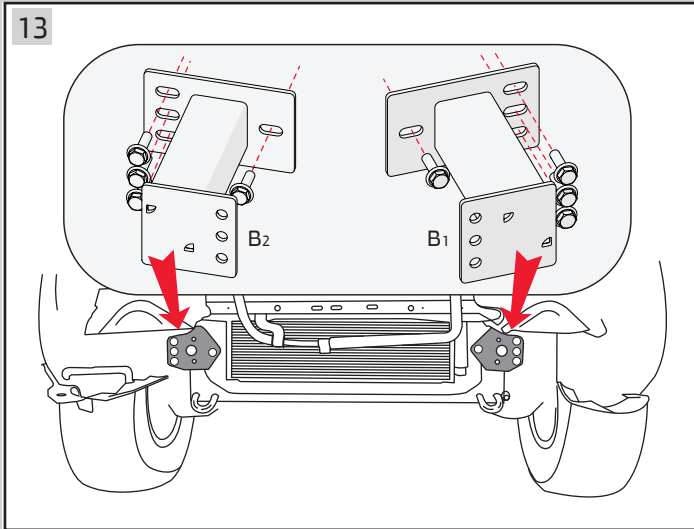

Use original bolts

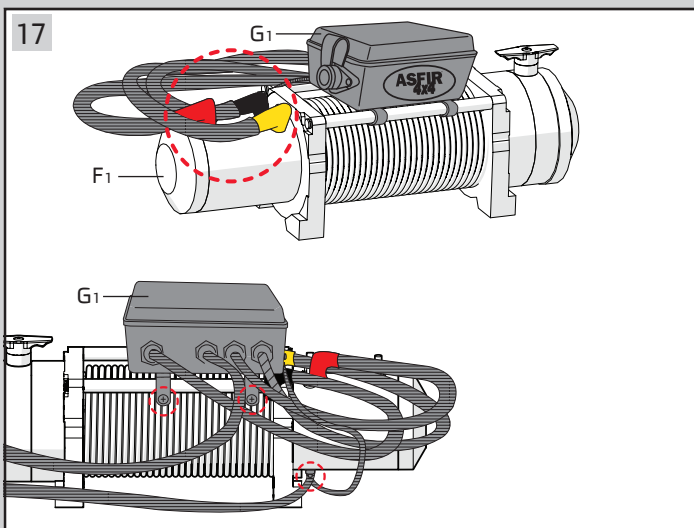
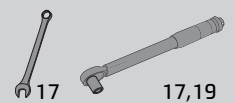
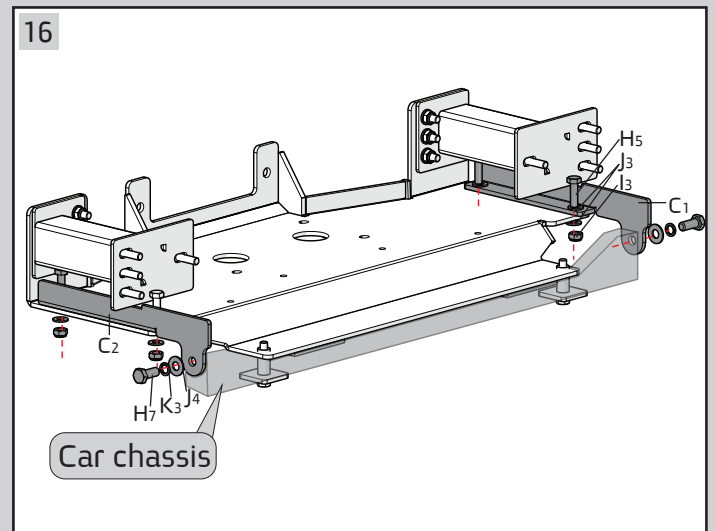
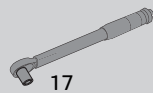
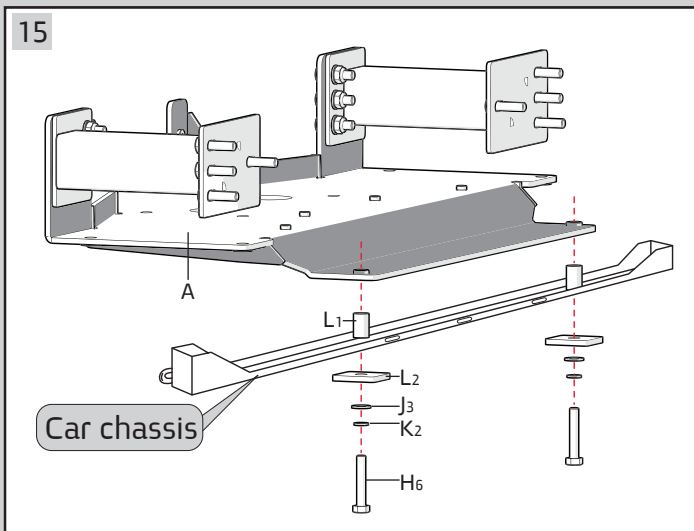
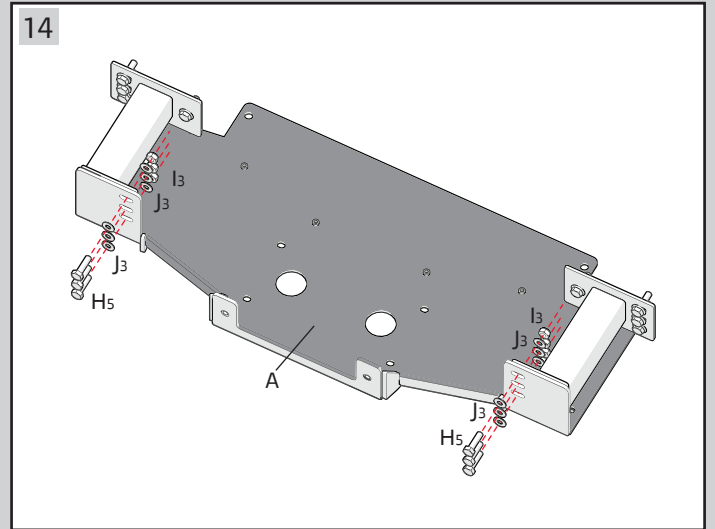
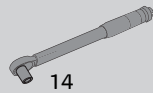

Place control box G₁ on the winch as shown above

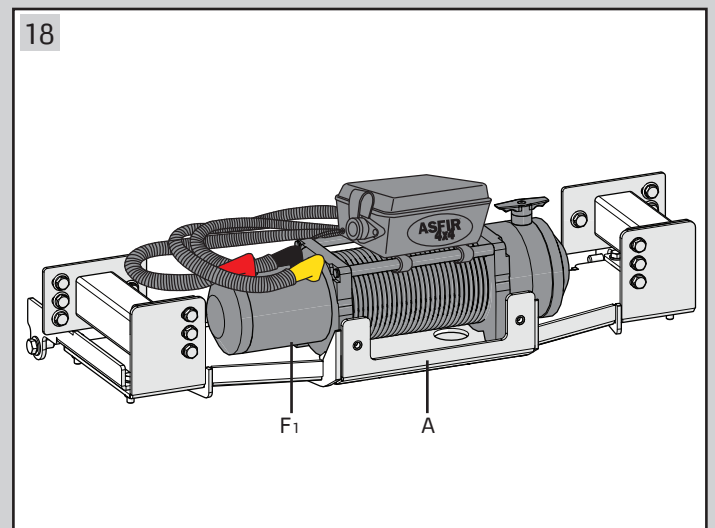
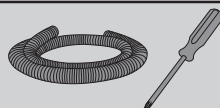

Place winch F₁ on plate A as shown above

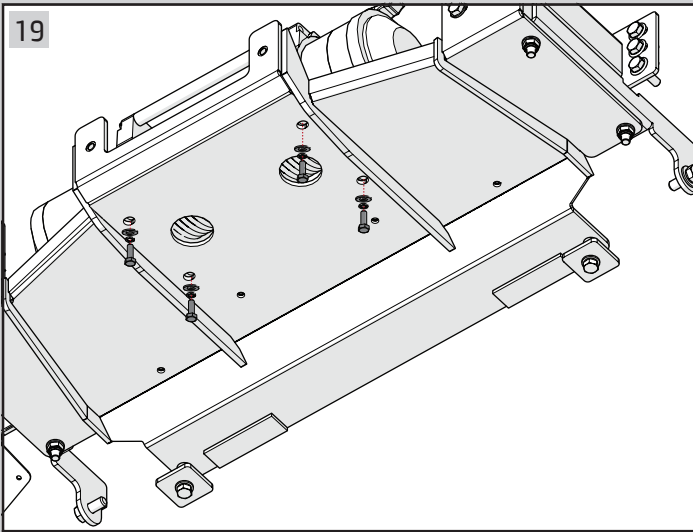

Bolts from ASFIR winch kit

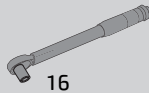

16

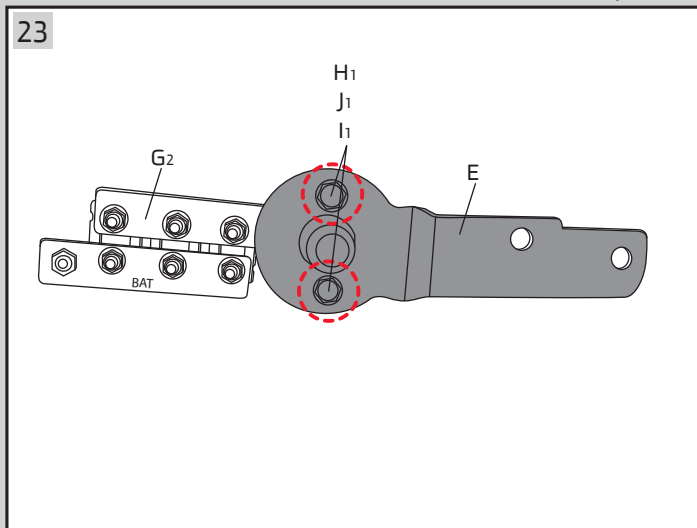
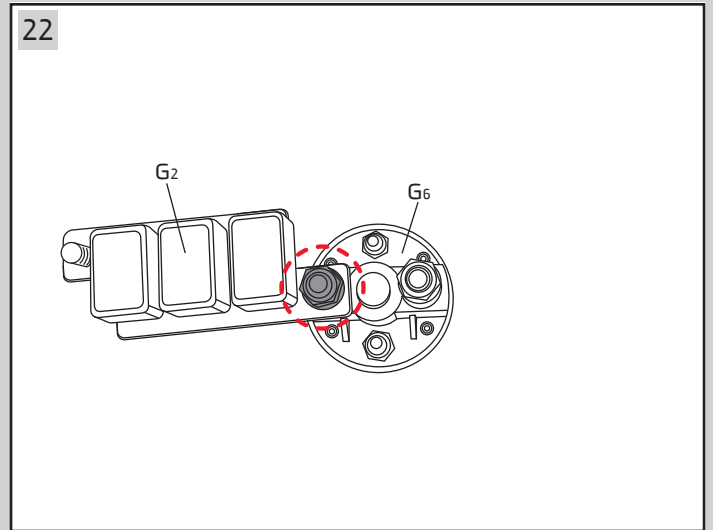
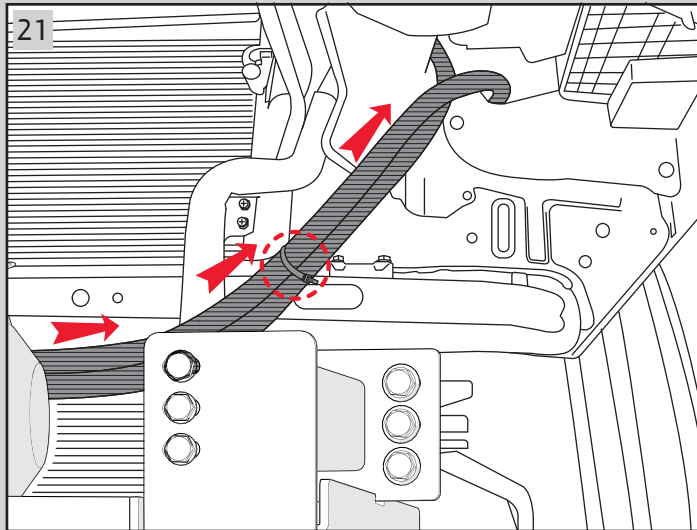
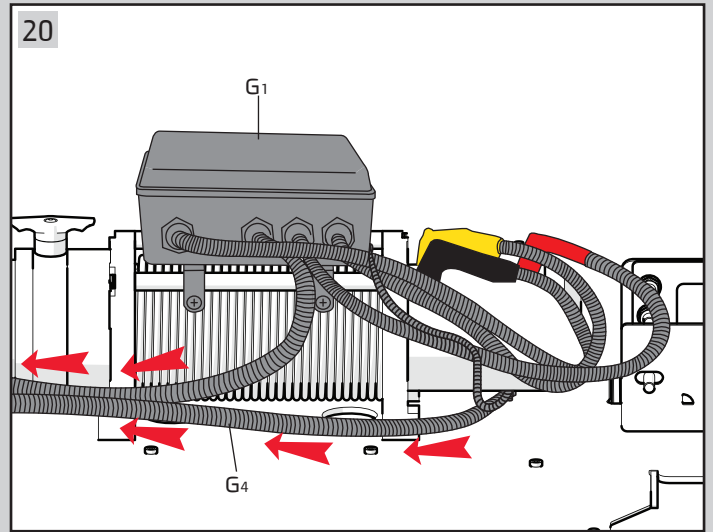

10

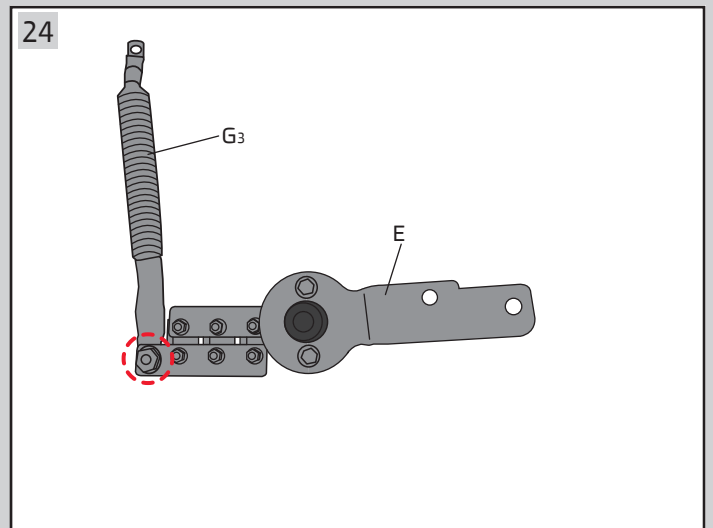

13

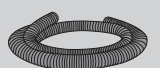

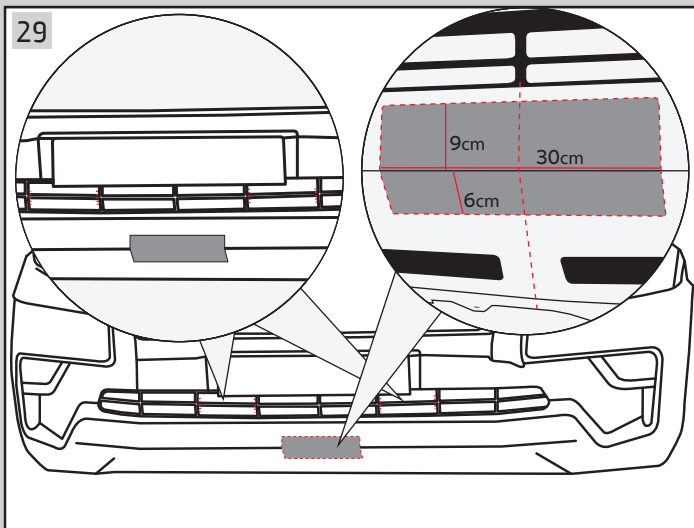
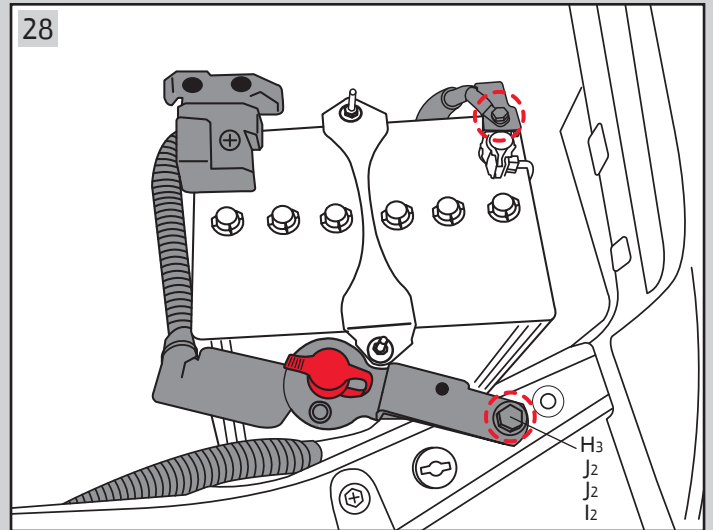
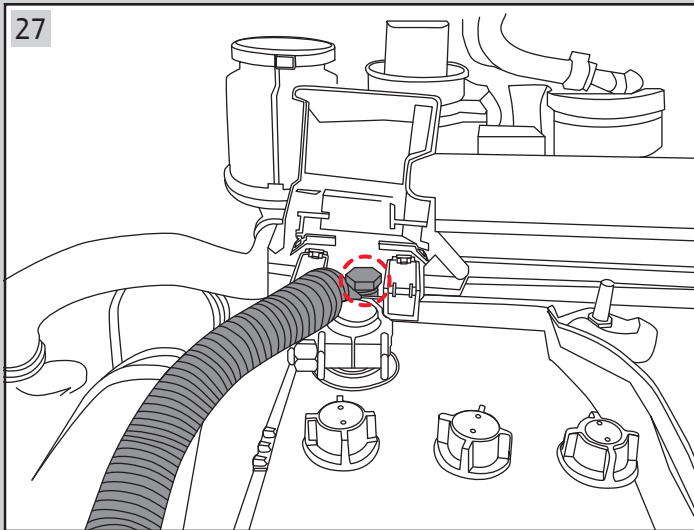
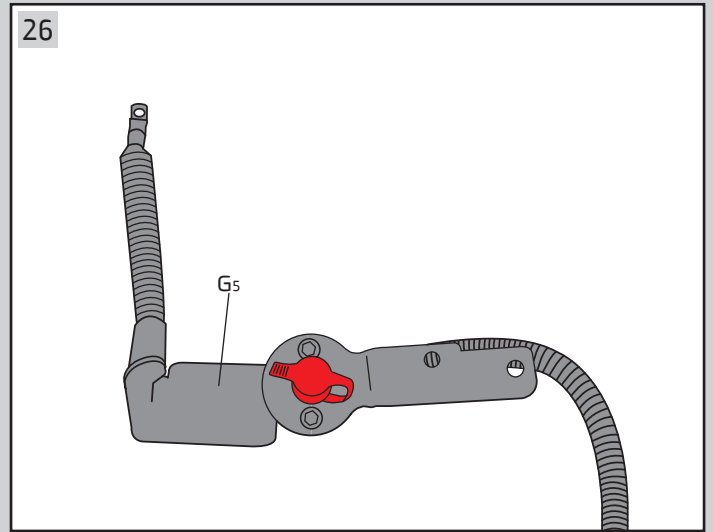
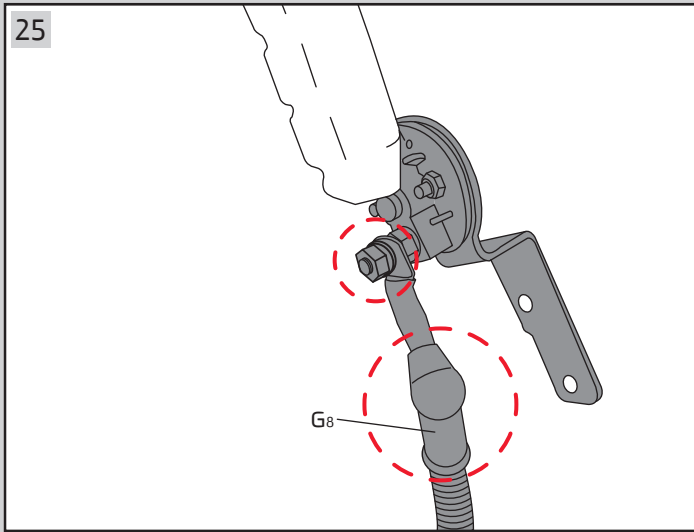

Cut the bumper as shown above

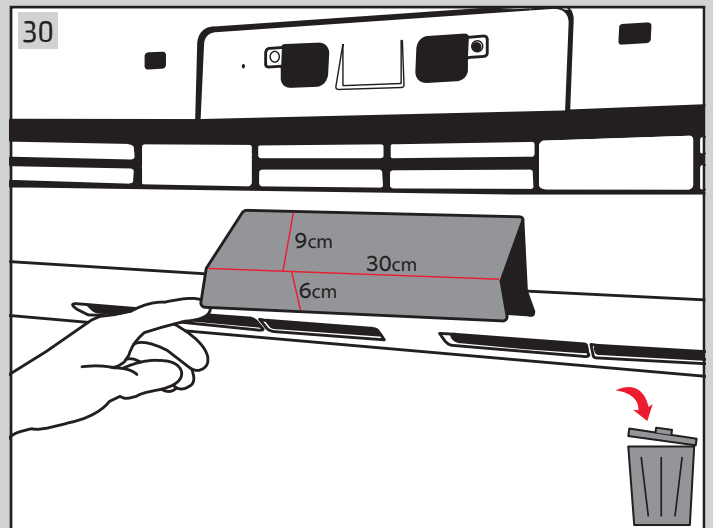

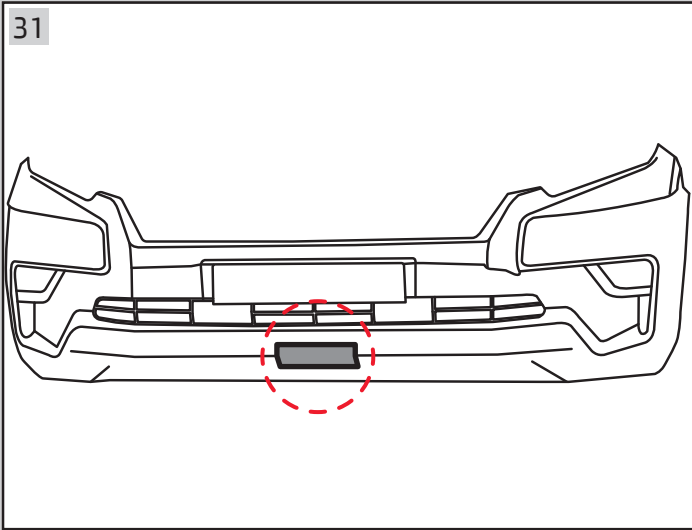

Cover the cutting line with rubber profile

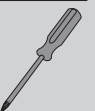
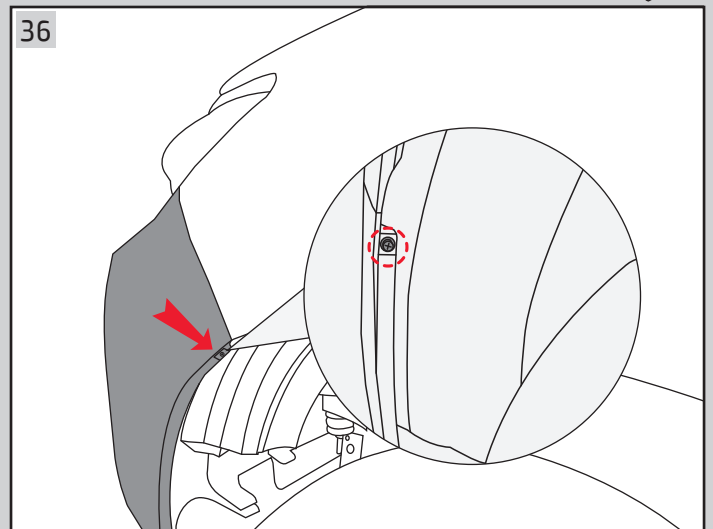
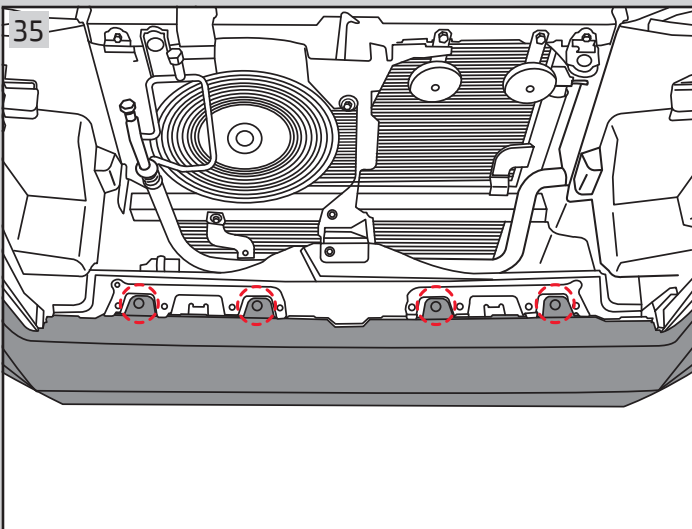
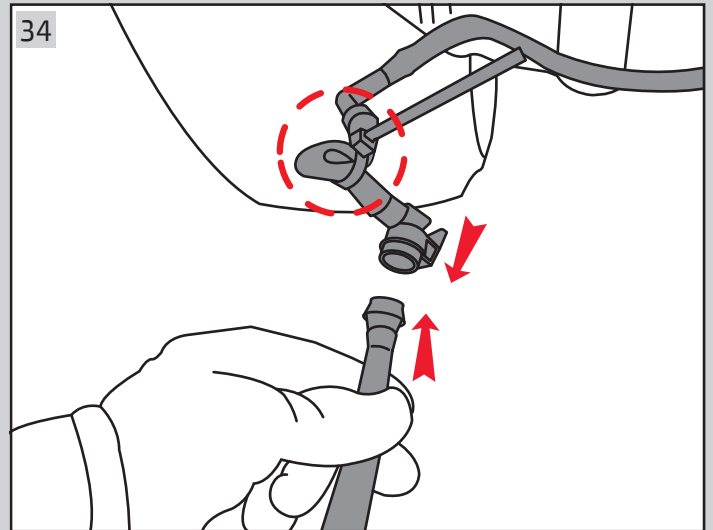
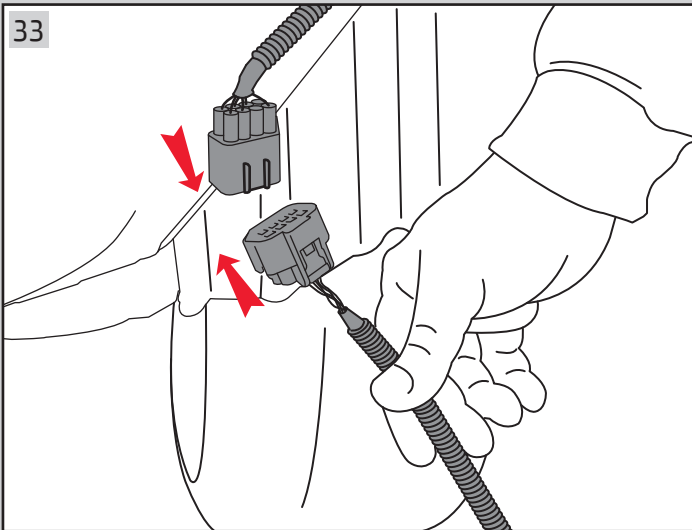
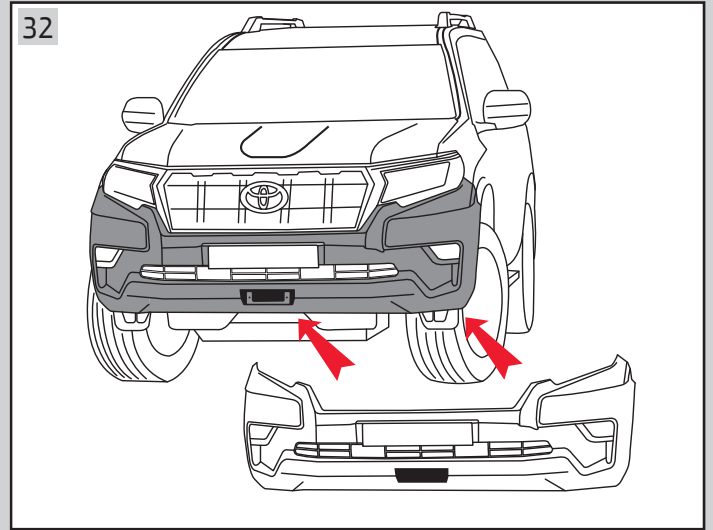

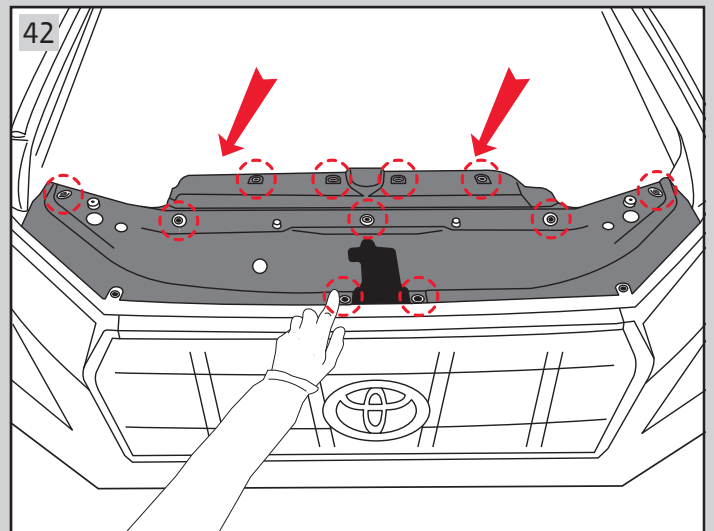
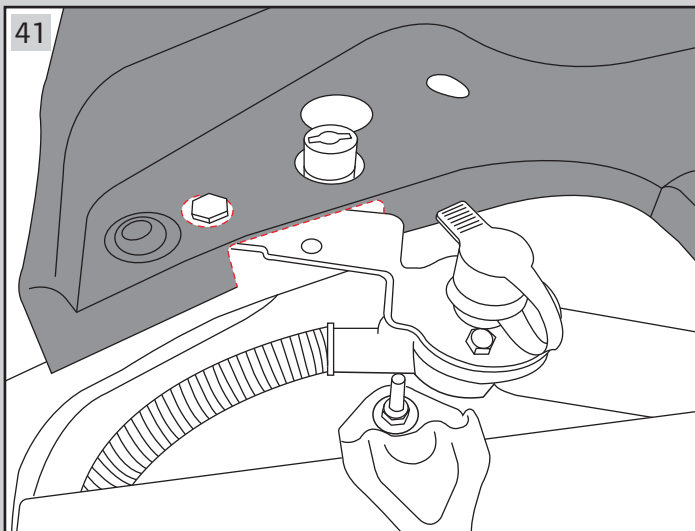
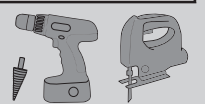
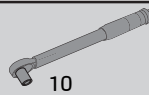
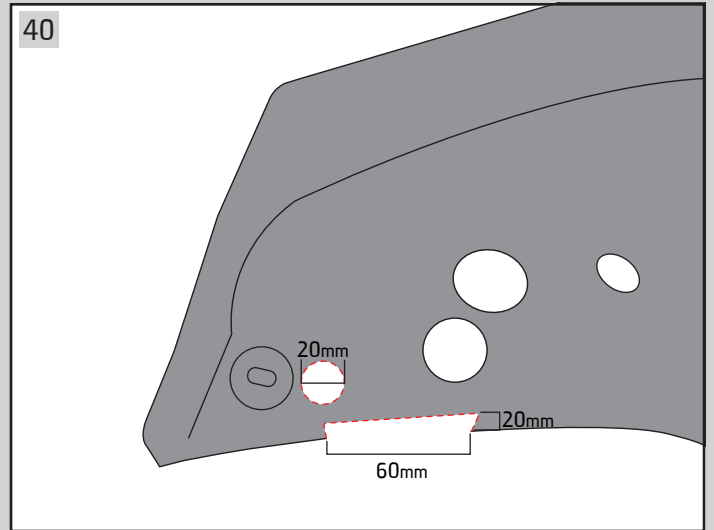
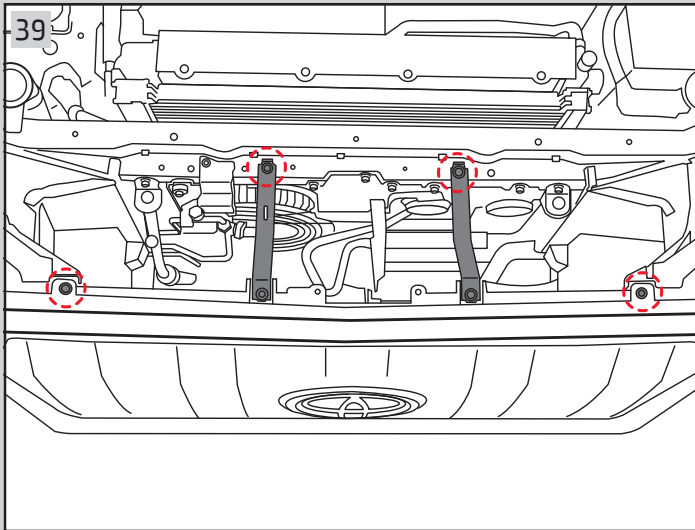
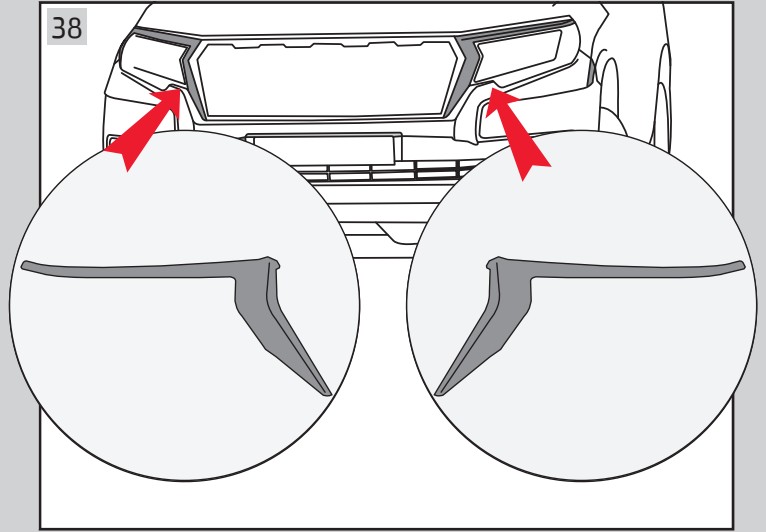
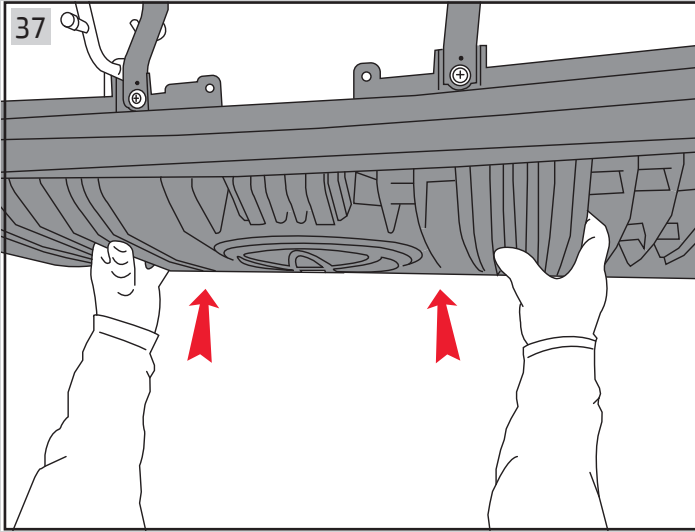

Reassemble back plastic tray and clips

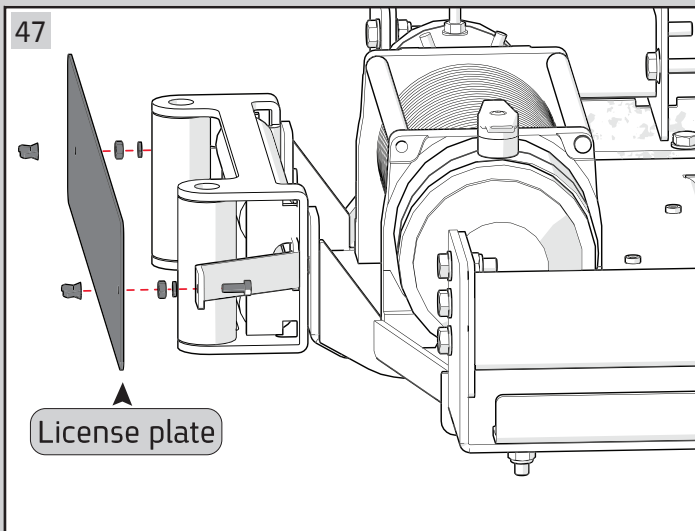
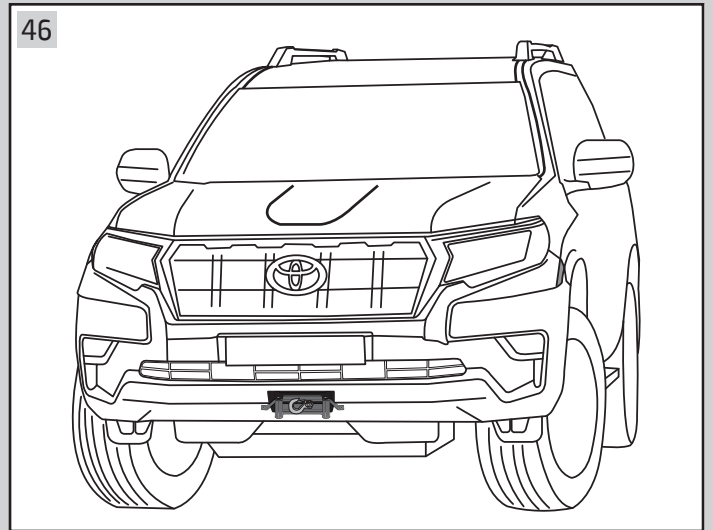
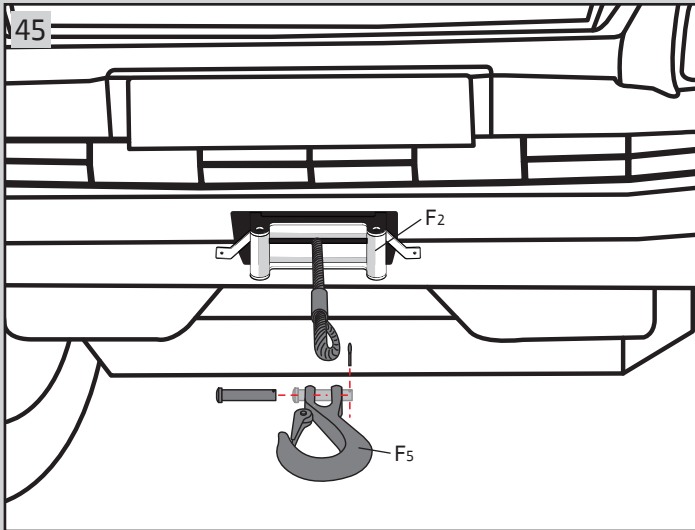
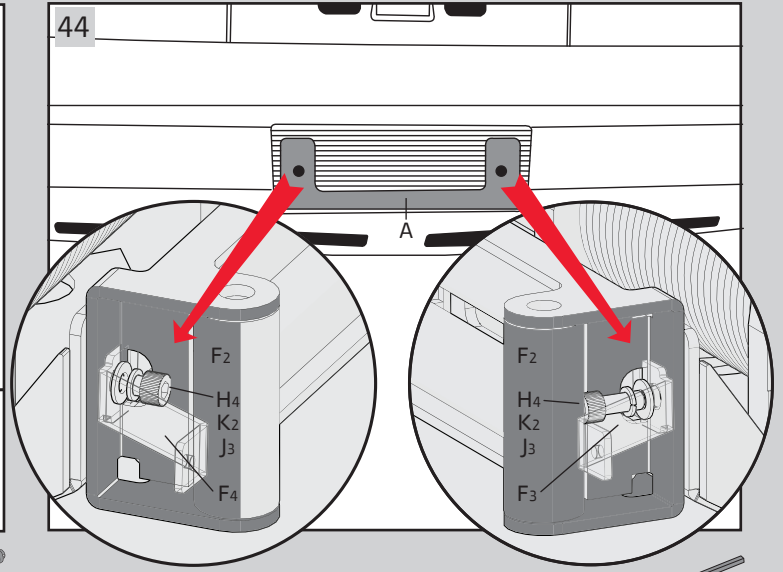
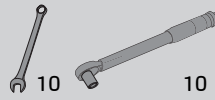
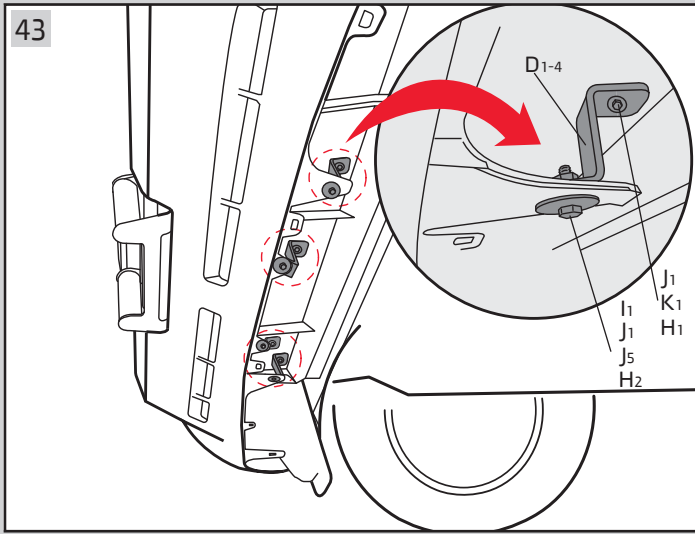

Bolts from ASFIR winch kit

