

Front differential skid plate

Mounting instructions

for Suzuki Jimny

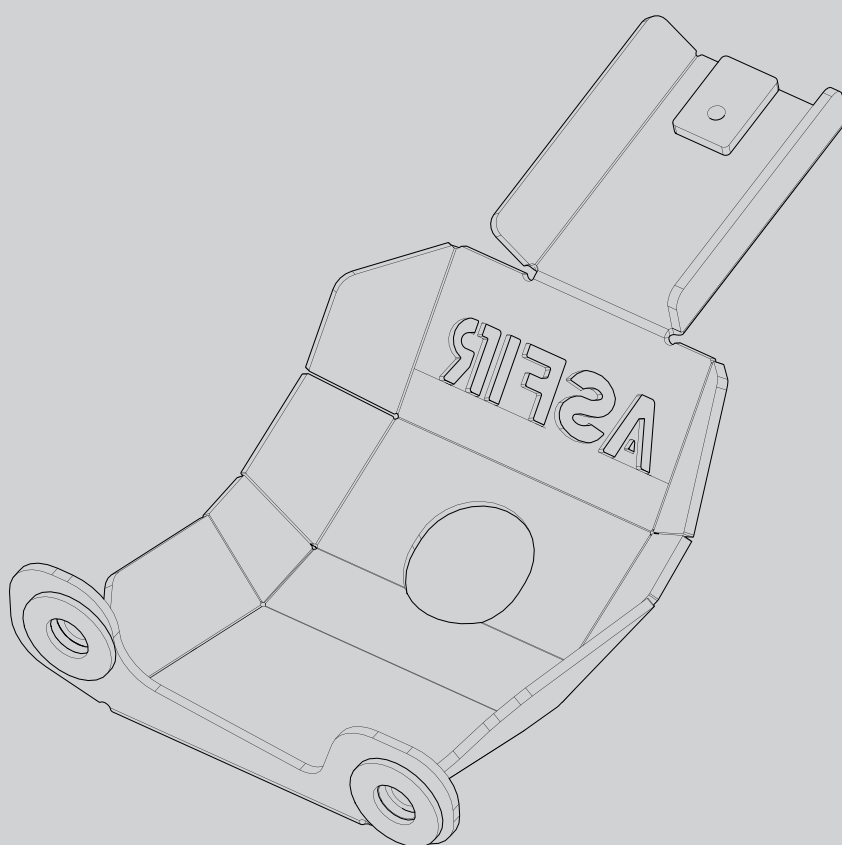

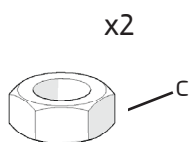
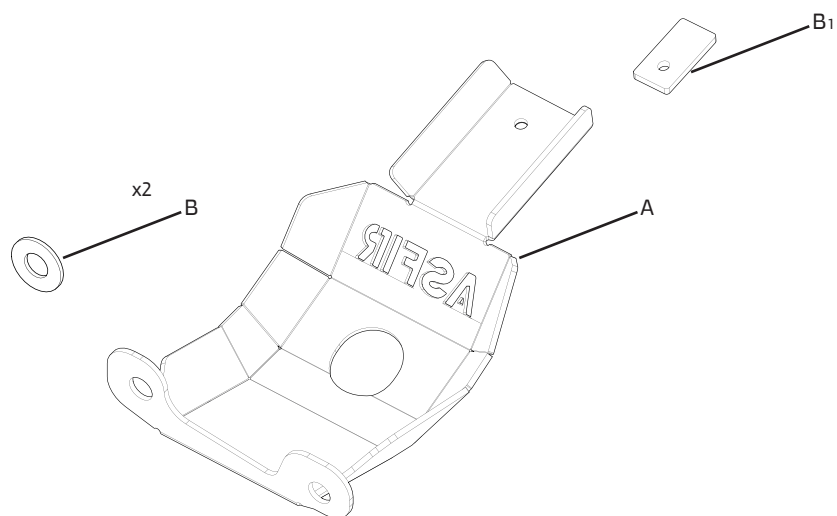

Hex Nut M12X1.25

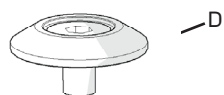

Flat socket head cap
allen screw M8X16

Maximum Tightening Torques	
M8 (8.8)	25 Nm
M12 (8.8)	90 Nm

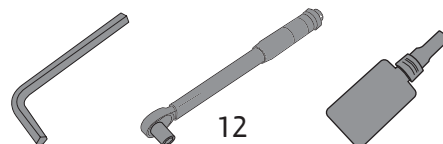

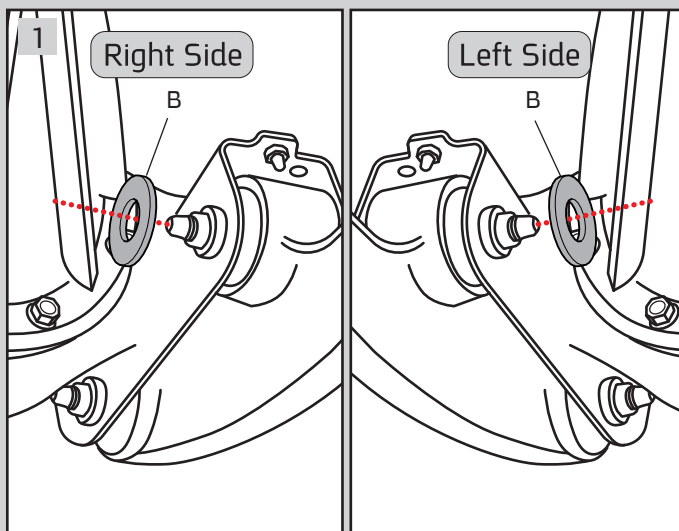

Insert washer (B)

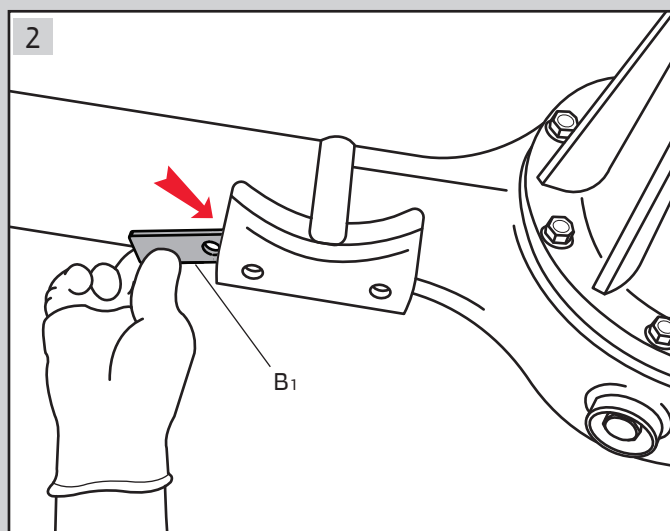

Insert bracket (B₁)

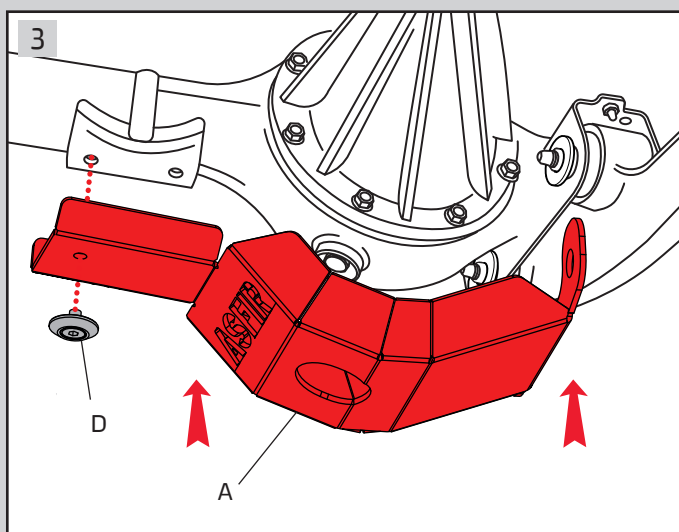

Connect differential skid plate (A) to bracket (B₁)
using kit bolt (D)
Tightening torque M8(8.8)-25Nm

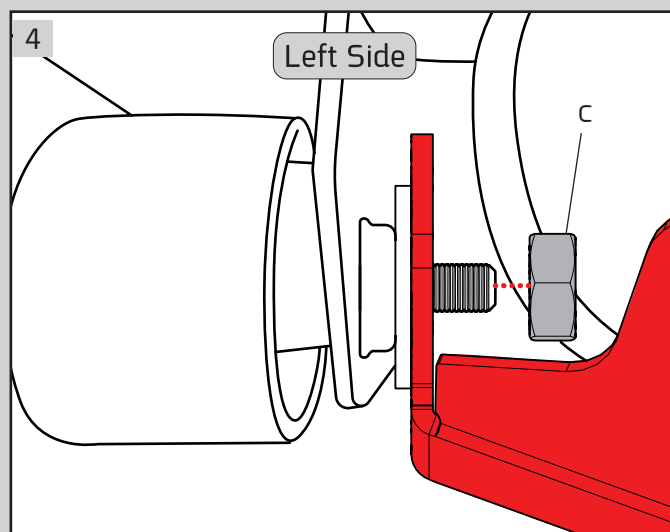

Using kit nut (C)
Add thread locker glue to original connection

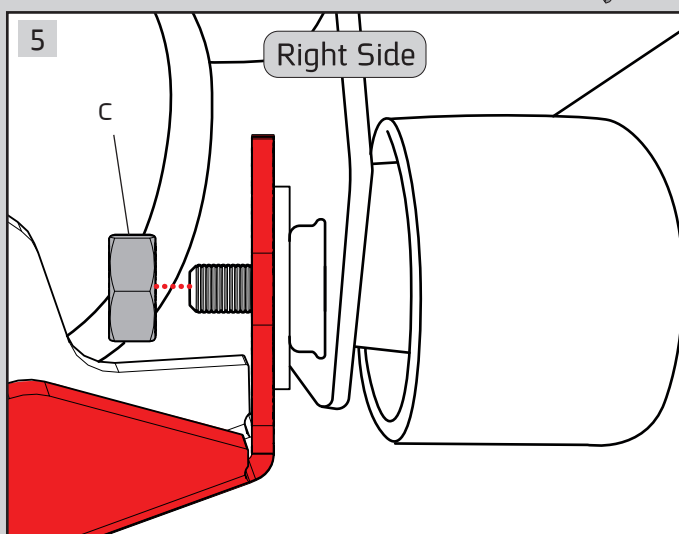

Using kit nut (C)
Add thread locker glue to original connection

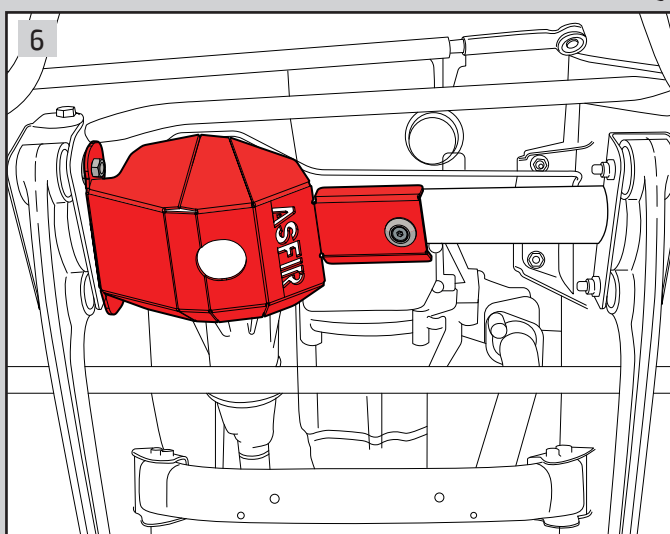

Tightening torque M12 (8.8)-90Nm, M8 (8.8)-25Nm